

## PWJDM Ruckus License Plate Relocator (Swingarm Straight)

### Installation Guide

This install will take about 15-30 minutes depending on how much you care about your bike. Since this thing vibrates more than the floozy living next door, we recommend you use light to medium strength threadlock on all the bolt threads. Do not use a high strength version or you'll never get this off again.

ITEM#	QTY	COMPONENT DESCRIPTION
1	1	PWJDM license plate bracket
2	2	Hex cap bolts
3	2	PWJDM washers
4	1	Locking washer
5	1	Flange bolt
6	1	Install manual

#### 1. Mount your license plate to the bracket.

- a. Assemble the hardware socket bolt through a colored washer, through the license plate, then thread into the bracket. We recommend you apply light to medium strength threadlock.

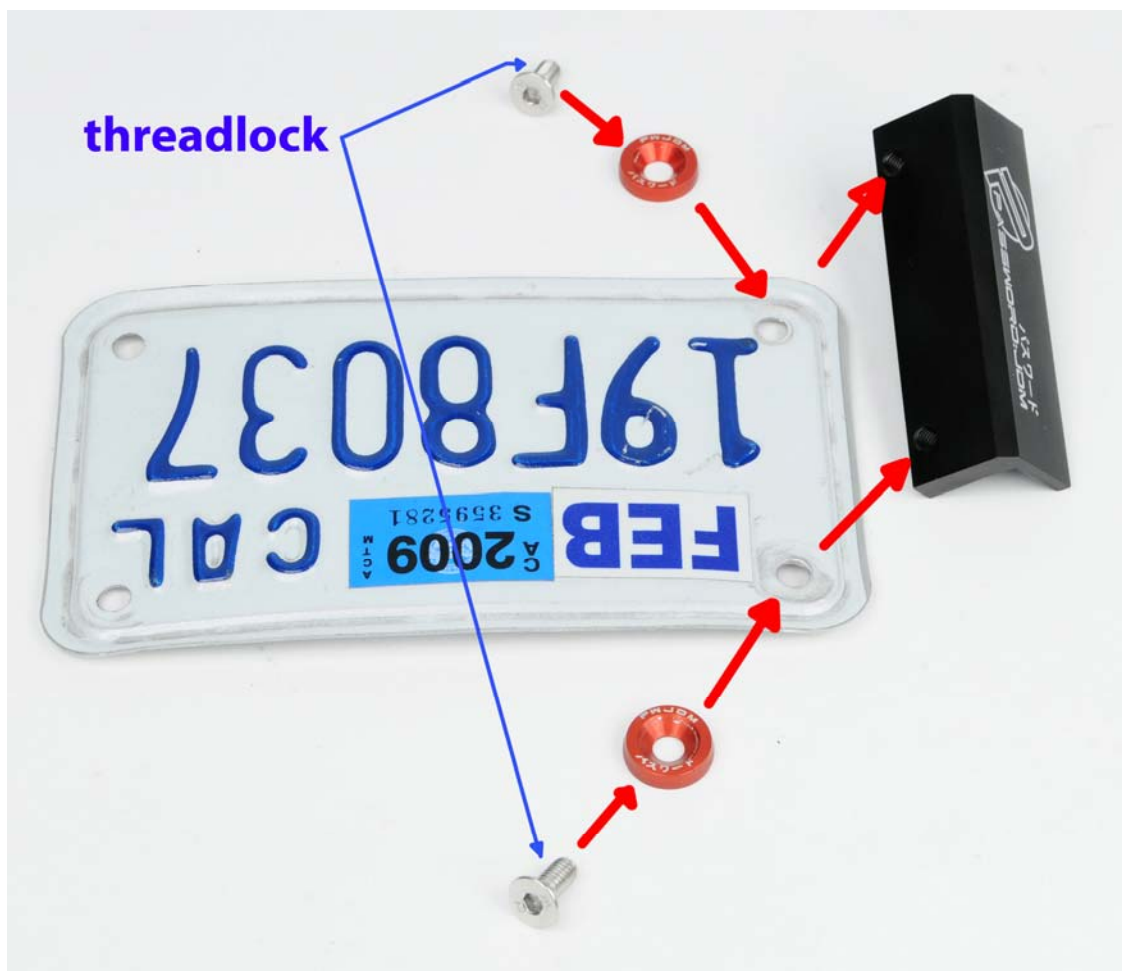

**2. Mount the assembly to the bike.**

- a. Put the long flange bolt through the locking washer, then through the bracket, and then into the threaded hole on your bike's swingarm. We recommend you apply light to medium strength threadlock. Tighten it down with a socket wrench.

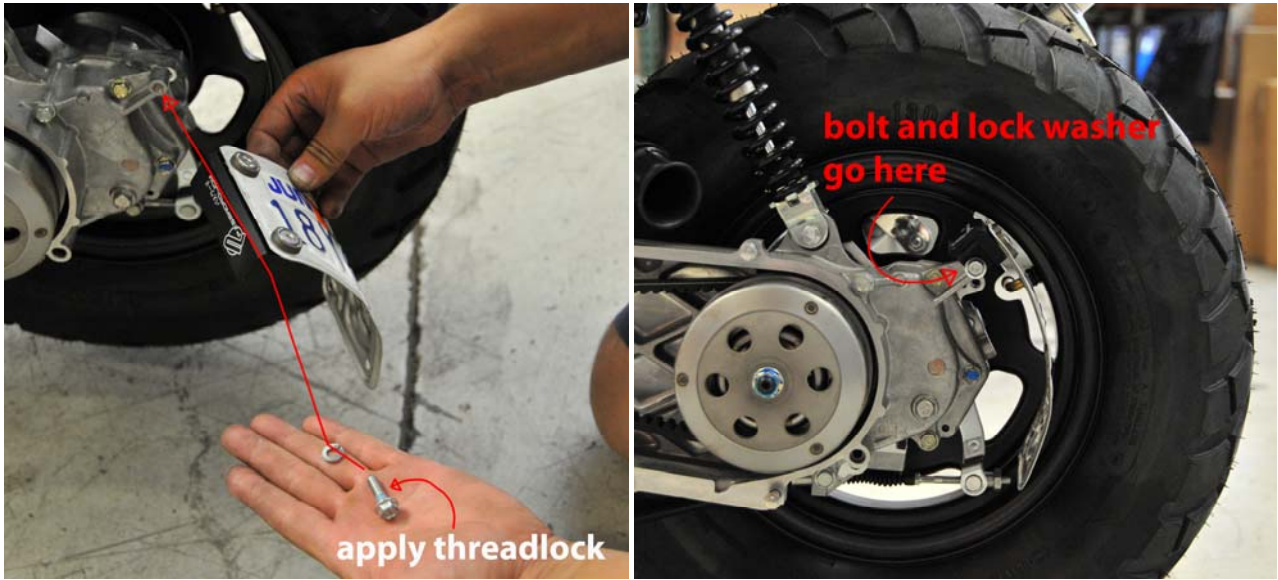

**3. Adjust your license plate.**

- a. Run it straight or bend it to follow the arc of your wheel. Do what you want, you're an adult now.



**4. Ride baby ride!**